

LETI - future academic space

LETI The Forum

Ideation

In the new landscape design, we hope to retain the original position of the trees, create an open square area, and retain the open area to correspond to the square in front of the new building, so that students and faculty will be the first stopping point when they enter the campus.

The flowing line is formed by concentrating the originally disorganized flowerbeds to form a smooth flowing line to enter the campus from the open space, Preserve the original planting area and provide a seating area in accordance with the planting. Use the sense of division on the main building to create angles and curves.



Splitting and rounding



Brutalism



Wireless Transmission

Ideation

In the design of the existing bush location, retain the original tree location Maintain the natural appearance without destroying the original green area

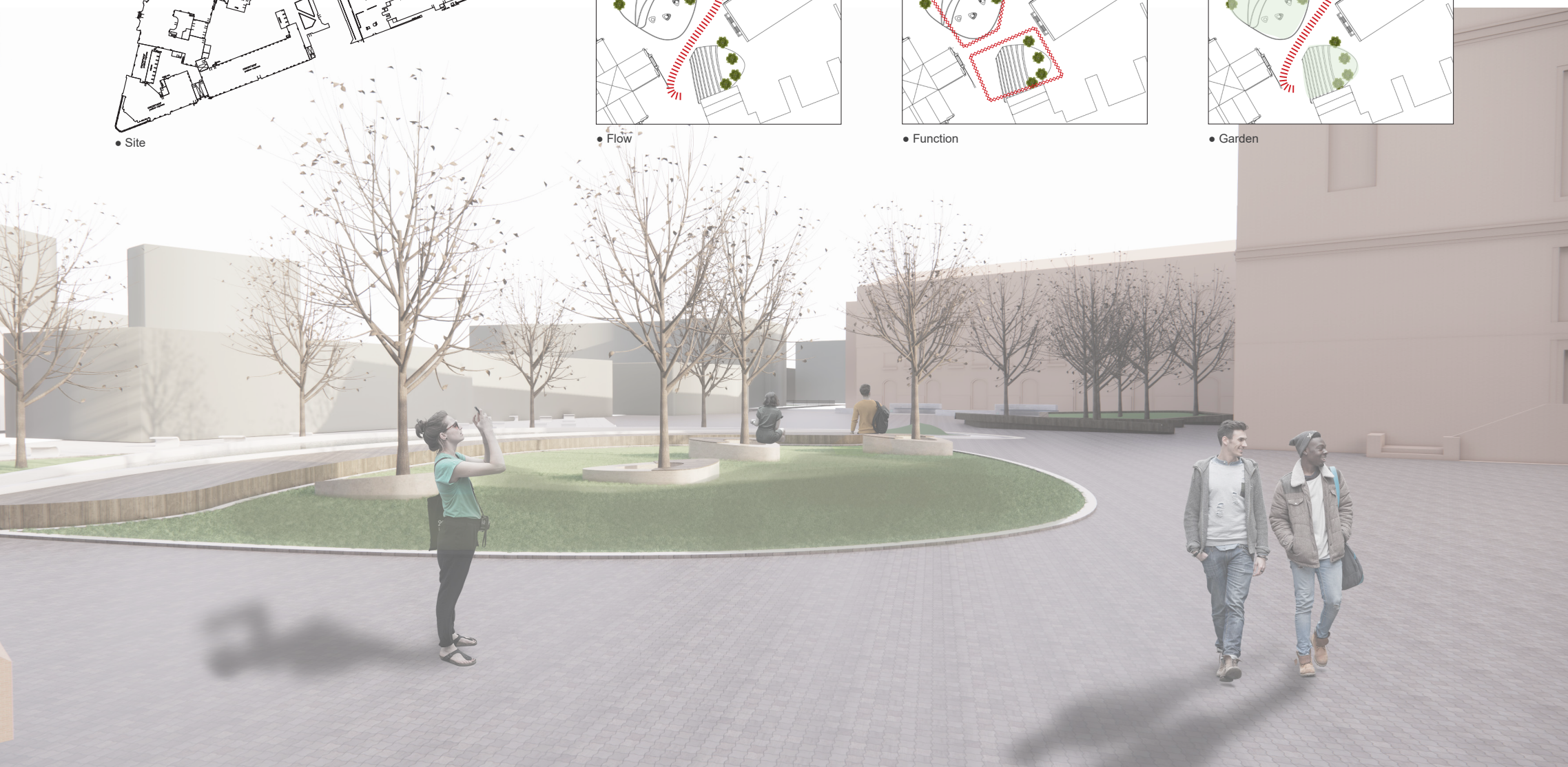

Design

When the pedestrian flow passes by, the passageway is preserved, and with the design concept, it is roughly divided into three areas according to the pedestrian flow and the location of trees, creating a flow speed and creating a vibrant campus.



• Before remodeling



• Before remodeling

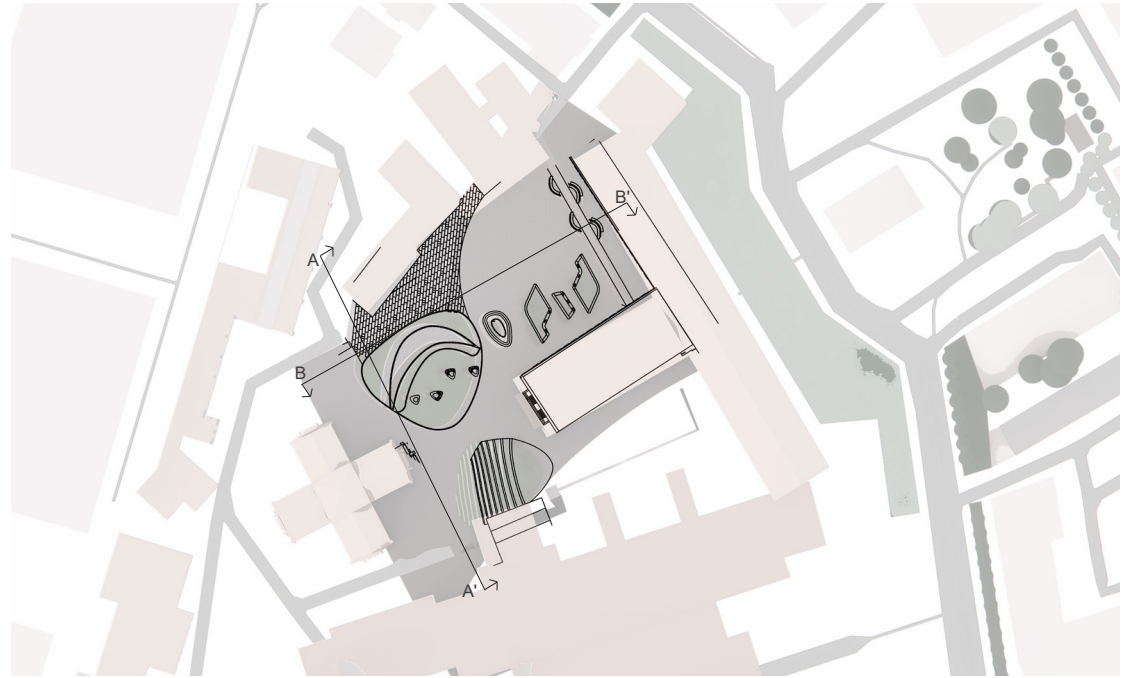

• Site Plan



• Section B-B'



• Section A-A'

